



## G2 SERIES INTRINSICALLY SAFE

A full line of **FLOMEC® G2 Series Turbine Meters** are available in a variety of housing materials. Rugged and dependable, the G2 Series offers:

- Stainless Steel for most water and chemical products
- Aluminum for fuels and petroleum-based products
- PVDF for aggressive chemicals

## FEATURES / BENEFITS

- Meter is designed for thin fluids < 100 cP
- Modular design allows for use with Output Modules, Sensors and Remote Display Kits
- 2 Totals (Batch Total = Resettable, Total = Non-Resettable); Rate of Flow, Factory calibrated in gallons or litres. Field calibratable. Includes non-volatile totals.
- High accuracy meter
- Internal parts are simple to replace for easy maintenance
- AAA Alkaline battery life: 2 years

## PRODUCT CONFIGURATION

### 1 PRODUCT IDENTIFIER:

**G2** = Industrial Grade Flowmeters

### 2 TURBINE MATERIAL:

**S** = Stainless Steel  
**A** = Aluminum  
**P** = PVDF (1/2 in. y 1 in. only)  
**X** = Electronics only (For metal meters)  
**Z** = Electronics only (For plastic meters)

### 3 TURBINE SIZE:

**05** = 1/2 in.                      **15** = 1-1/2 in.  
**07** = 3/4 in.                      **20** = 2 in.  
**10** = 1 in.

### 4 FITTING TYPE:

**N** = NPT (Female)  
**I** = ISO (Female) BSPT (ISO 7 Designation is RC)  
**F** = 150# ANSI Flange (Available on S10, S15 & S20 only)  
**T** = Tri-Clover® Fitting (Available on S05, S07, S10, S15 & S20 only)  
**X** = No Turbine Body

### 5 ELECTRONIC CHOICE:

*Computer Display, Meter Mounted*  
**Q9** = Q9 2-Button Computer  
**Q1** = Q9 2-Button Computer, Vertical Mount (90° Adapter)  
*Retrofit Computer Kit (Display Only)*  
**R9** = Q9 2-Button Computer Retrofit Kit (Replaces Q9 Display)  
*No Electronics - Turbine Only*  
**XX** = No Electronics - Turbine Only

### 6 CALIBRATION OF COMPUTER / DISPLAY:

**GM** = Gallons Per Minute (Gallons Default)  
**LM** = Liters Per Minute (Litres Default)  
**GD** = Gallons Per Minute (Gallons Default) with NIST Certificate  
**LD** = Liters Per Minute (Litres Default) with NIST Certificate  
**XX** = No Calibration

### 7 PACKAGING:

**A** = 05 Thru 10 Turbines, Turbine Only or w/Q9 Electronics  
05 Thru 20 Electronics Only (Q9 Replacement Kit or R9 Retrofit Kit)  
**B** = 15 & 20 Turbines, Turbine Only or w/Q9 Electronics  
05 Thru 10 Turbines w/Q1 Electronics  
**C** = 15 Thru 20 Turbine w/Q1 Electronics  
**D** = 10 Turbines with ANSI Flange Turbine Only or w/Q9, Q1 Electronics  
**E** = 15 & 20 Turbines with ANSI Flange Turbine Only or w/Q9, Q1 Electronics

## APPLICATIONS

- Batching
- Blending
- Water
- Industrial fluids
- Plating solutions
- Ammonium
- Food and beverage processing
- Fuel Products
- Monitoring clean fluids
- Plant process water
- Chemical feed lines
- Harsh chemicals (sulfuric acid and bleach)

1 2 3 4 5 6 7

---->>>> G2 S 15 N Q9 GM B



# SPECIFICATIONS

Fitting Type:	NPT or ISO (Female) BSPT (ISO 7 designation is RC)				
	150# ANSI (S10, S15 y S20 only)				
	Tri-Clover® (Stainless Steel only) - Fitting size is one size bigger than meter size				
Meter Sizes Available:	1/2"	3/4"	1"	1-1/2"	2"
Corresponding Tri-Clover® Fitting:	3/4"	1"	1-1/2"	2"	2-1/2"
Housing Material:	316 Acero Inoxidable, Aluminio, PVDF				
Flow Range:	1/2" (05)	1 - 10 GPM		(3.8 - 38 L/min)	
	1/2" (05) PVDF Only	1.2 - 12 GPM		(4.5 - 45 L/min)	
	3/4" (07)	2 - 20 GPM		(7.6 - 76 L/min)	
	1" (10)	5 - 50 GPM		(19 - 190 L/min)	
	1-1/2" (15)	10 - 100 GPM		(38 - 380 L/min)	
	2" (20)	20 - 200 GPM		(76 - 760 L/min)	
Accuracy (% of Reading):	Turbine Only		Turbine w/Computer		
	1/2" (05)	± 2.0%		± 1.5%	
	3/4" (07)	± 1.5%		± 1.0%	
	1" (10)	± 1.5%		± 1.0%	
	1-1/2" (15)	± 1.0%		± 0.75%	
	2" (20)	± 1.0%		± 0.75%	
Repeatability:	± 0.1% (PVDF is ± 0.3%)				

## DIMENSIONS NOTE: Q9 Display adds 0.72 in. (18 mm) to height

### Stainless Steel Models

	S05, 1/2 in.	S07, 3/4 in.	S10, 1 in.	S15, 1 1/2 in.	S20, 2 in.
A = Height	1.4 in. (35.6 mm)	1.6 in. (40.6 mm)	1.9 in. (48.3 mm)	2.6 in. (66.0 mm)	3.1 in. (78.7 mm)
B = Width	2.0 in. (50.8 mm)	2.0 in. (50.8 mm)	2.0 in. (50.8 mm)	2.7 in. (68.6 mm)	3.4 in. (86.4 mm)
C = Length	4.2 in. (106.7 mm)	4.3 in. (109.2 mm)	4.5 in. (114.3 mm)	5.3 in. (134.6 mm)	6.3 in. (160.0 mm)

### Aluminum Models

	A05, 1/2 in.	A07, 3/4 in.	A10, 1 in.	A15, 1 1/2 in.	A20, 2 in.
A = Height	1.8 in. (45.7 mm)	2.0 in. (50.8 mm)	2.2 in. (55.9 mm)	2.8 in. (71.1 mm)	3.2 in. (81.3 mm)
B = Width	2.0 in. (50.8 mm)	2.0 in. (50.8 mm)	2.0 in. (50.8 mm)	2.7 in. (68.6 mm)	3.3 in. (83.8 mm)
C = Length	4.2 in. (106.7 mm)	4.3 in. (109.2 mm)	4.5 in. (114.3 mm)	5.3 in. (134.6 mm)	6.3 in. (160.0 mm)

### PVDF Models

	P05, 1/2 in.	P10, 1 in.
A = Height	3.2 in. (81.3 mm)	3.3 in. (83.8 mm)
B = Width	2.1 in. (53.3 mm)	2.8 in. (71.1 mm)
C = Length	7.3 in. (185.4 mm)	8.1 in. (205.7 mm)

*NOTE: For representation purpose only. Actual product models vary in shape, design, etc*

*ANSI Flange and Sanitary Flange dimensions not shown. For those dimensions, please refer to product manuals or our website FLOMEcmeters.com.*

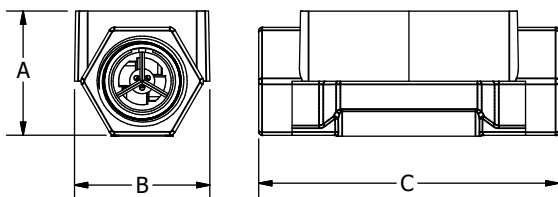

<b>Pressure Rating:</b>	
<b>Stainless Steel 316 SS</b>	1,500 psi (102 bar)
<b>Aluminum</b>	300 psi (21 bar)
<b>ANSI Flange 316 SS</b>	Flange Rule
<b>Sanitary Flange 316 SS</b>	Limited by fitting, clamp size, & temperature
<b>PVDF</b>	100 psi (6.9 bar)
<b>Operating Temperature Range:</b>	-40° F to 250° F (-40° C to 121° C)
	(PVDF) -20° F to 180° F (-28° C to 82° C)
<b>with Intrinsically Safe Display:</b>	0° F to +129° F (-18° C to +54° C)
<b>Typical K-Factor:</b>	1/2" (05) 2,500 PPG (660 Pulses/L)
	3/4" (07) 1,100 PPG (291 Pulses/L)
	1" (10) 565 PPG (149 Pulses/L)
	1-1/2" (15) 215 PPG (57 Pulses/L)
	2" (20) 100 PPG (26 Pulses/L)
<b>Wetted Materials:</b>	Housing: 316 Stainless Steel or Aluminum
	Bearings: 96% Alumina Oxide Ceramic
	Shaft: Tungsten Carbide
	Rotor: PVDF
	Rings: 316 Stainless Steel
<b>Wetted Materials PVDF:</b>	Housing: PVDF (15% Carbon Fiber Filled)
	Bearings & Shaft: 98% Alumina Ceramic
	Rotor: PVDF
	Rings: Fluorocarbon (Optional PTFE)
<b>Frequency Range:</b>	1/2" (05) 42-420 Hz @ 1-10 GPM (3.8-38 L/min) / 45-450 Hz @ 1.2-12 GPM (4.5-45 L/min) (PVDF)
	3/4" (07) 37-370 Hz @ 2-20 GPM (7.6-76 L/min)
	1" (10) 47-470 Hz @ 5-50 GPM (19-190 L/min) / 45-475 Hz @ 5-50 GPM (19-190 L/min) (PVDF)
	1-1/2" (15) 36-360 Hz @ 10-100 GPM (38-380 L/min)
	2" (20) 33-330 Hz @ 20-200 GPM (76-760 L/min)
<b>Calibration Report:</b>	Comes standard with G2 Series meters.
	N.I.S.T. - Certification available.

## ACCESSORIES

Part No.	Description	Part No.	Description
120077-01	FM Approved Sensor	113275-10	FM Approved Remote Kit
120077-02	ATEX Approved Sensor	125206-2	1/2 in. Teflon O-Ring for PVDF Meter (2)
125260-02	90° Display Adaptor Kit	125206-1	1 in. Teflon O-Ring for PVDF Meter (2)

## APPROVALS

